

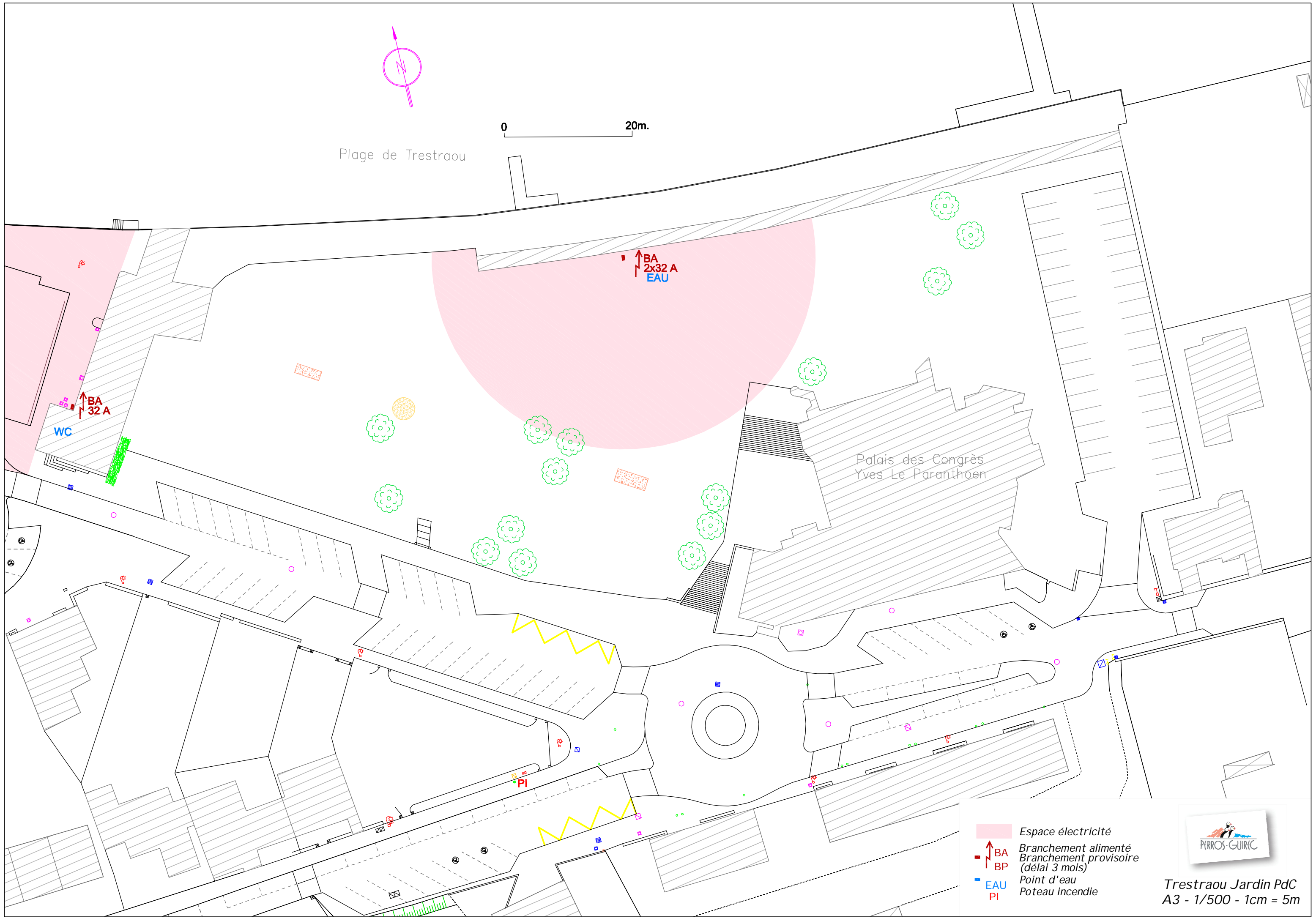







0 20m.

Plage de Trestraou



-  Espace électricité
  -  BA
  -  BP
  -  EAU
  -  PI
- Branchement alimenté  
Branchement provisoire  
(délai 3 mois)
- Point d'eau  
Poteau incendie



Trestraou Jardin PdC  
A3 - 1/500 - 1cm = 5m